



House & Land Package

From **\$939,000***

Pikes Peak 2146

3 2 3

28600 Sonny Drive, Wesley Chapel

Land Area: 2.39 ac

Contact **Jennifer Hmielewski** on **6155690165**

Inclusions:

- + Land Listed By: Ryan Snyder. Contact agent directly for land inquiries: 727-307-7618
 - + Included in Pricing: Well/Septic System \$25,000.00 Allowance
 - + Included in Pricing: Permit & Impact Fee of \$20,000 Allowance
 - + Included in Pricing: Site Preparation Allowance of \$10,000
 - + Home Built to our Craftsman Standard Inclusions
 - + New Home Sales Consultant for Floor Plan and Building
- Questions: Jennifer Hmielewski. Please contact her directly for build questions: 615-569-0165

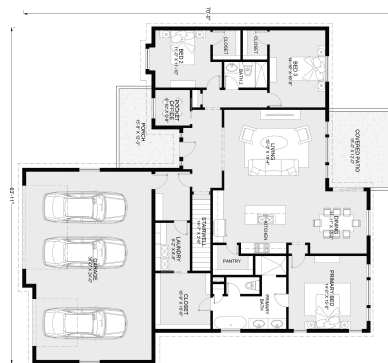

NOTE: Images may depict landscaping and upgraded fixtures, features, facades or finishes and other items which are not included in the prices stated or not supplied by G.J. Gardner Homes. For availability and pricing of these items please discuss with your new home sales consultant.

